

FOR SALE BY PRIVATE TREATY

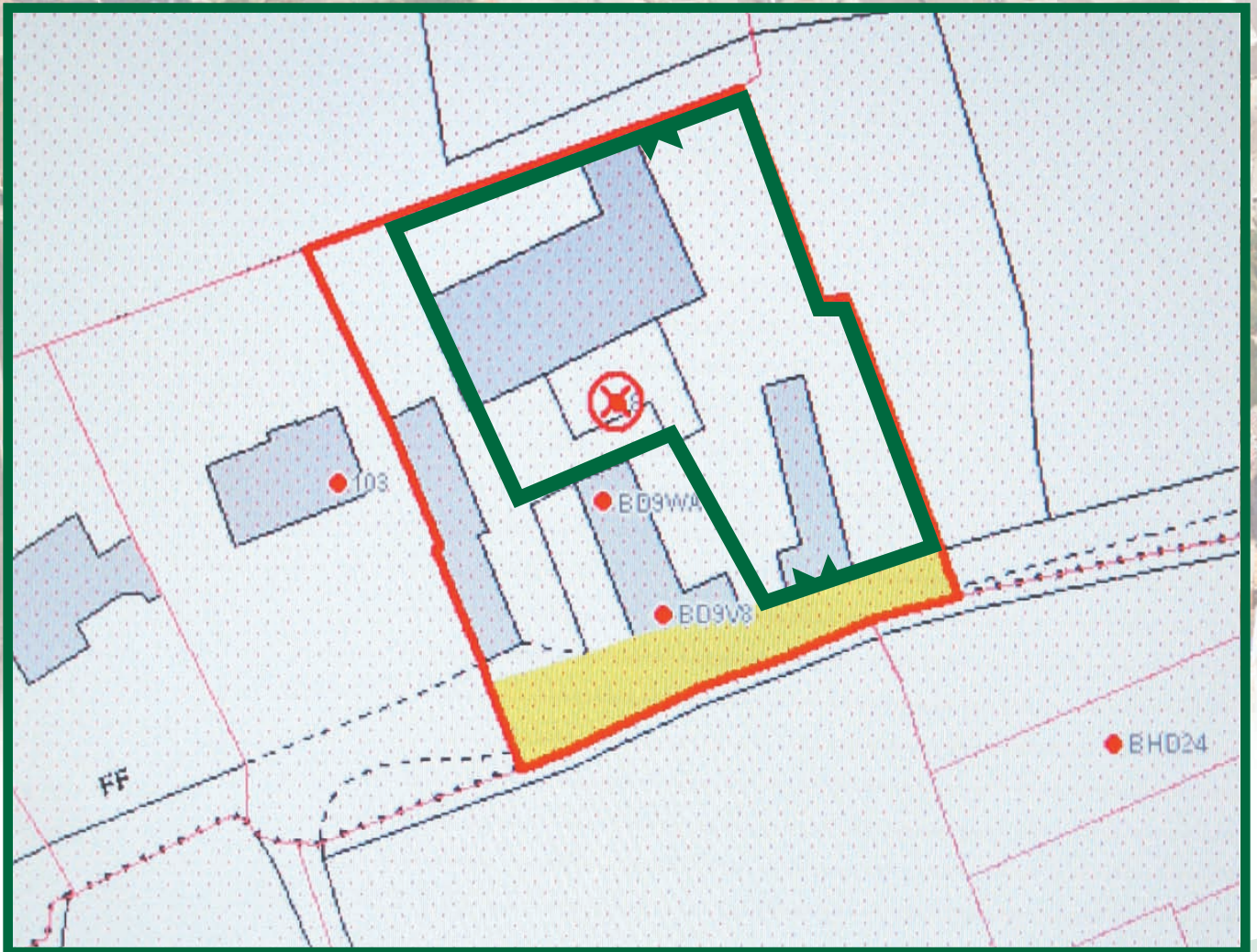

0.7 ACRE SITE AT
DONACARNEY GREAT, EASTHAM ROAD
BETTYSTOWN, CO. MEATH

Planning permission has been lodged for five residential blocks comprising of 20 residential units in total. Each block is to consist of 2x2bed apartments on the ground floor, with 2x3 bed apartments over the upper floors, with hall, living and kitchen at first floor level, with three bedrooms and bathroom at second floor level. Permission is also in place to tie into the services in the adjoining estate (Castlemartin Estate). Please see above map.

DESCRIPTION

Eastham Road is located in the popular village of Bettystown, which is well catered for by all local amenities and only a short drive from Drogheda. Sandy beaches are a short stroll away at Bettystown, Laytown and Mornington. The new Bettystown Town Centre is in the process of being built at present due for completion in 2009, with popular retailers secured such as Tesco. It is within close proximity to train stations at both Drogheda and Laytown, and within a ten minute drive to the M1 motorway, allowing easy commuting time to Dublin city centre. Eastham Road is a much sought after residential area in Bettystown.

Guide price: €1,000,000



Fairview, Dublin 3.
Drogheda, Co. Louth.
Balbriggan, Co. Dublin.
Navan, Co. Meath.
Newbridge, Co. Kildare.

Phone: 01 853 4122
Phone: 041 98 44444
Phone: 01 841 1940
Phone: 046 90 78244
Phone: 045 486 080

